

UNIVERSAL PULL CLAMP & ROTATING RING

Model RE92/20

PARTS DETAILS

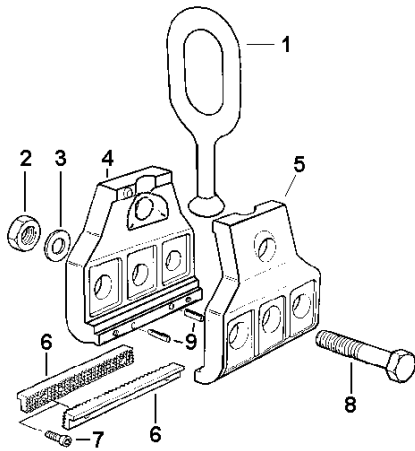

Item	Part No.	Description	Item	Part No.	Description
1	184.D2510300	Ring, Rotating	6	184.D4030600	Clamp Plate
2	184.C0005226	Nut, M16	7	184.C0004005	Screw, M5x10
3	184.C0006517	Plain Washer, D16	8	184.C0000142	Screw, M16x85
4	184.D6000500	Jaw, Threaded	9	184.C0010515	Pin, D5x14
5	184.D6000600	Jaw, Plain			

For a copy of our latest catalogue and promotions call us on 01284 757525 and leave your full name, address and postcode.



Sole UK Distributor, Sealey Group,
 Bury St. Edmunds, Suffolk.
 E-mail: sales@sealey.co.uk
 Web: www.sealey.co.uk

RE92/20 - 1 - 260902

UNIVERSAL PULL CLAMP & ROTATING RING

Model RE92/20

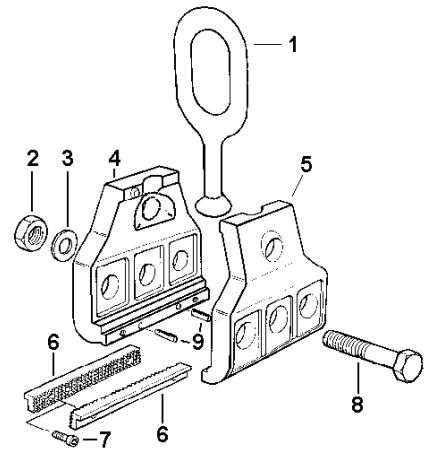
PARTS DETAILS



Item	Part No.	Description	Item	Part No.	Description
1	184.D2510300	Ring, Rotating	6	184.D4030600	Clamp Plate
2	184.C0005226	Nut, M16	7	184.C0004005	Screw, M5x10
3	184.C0006517	Plain Washer, D16	8	184.C0000142	Screw, M16x85
4	184.D6000500	Jaw, Threaded	9	184.C0010515	Pin, D5x14
5	184.D6000600	Jaw, Plain			

For a copy of our latest catalogue and promotions call us on 01284 757525 and leave your full name, address and postcode.



Sole UK Distributor, Sealey Group,
 Bury St. Edmunds, Suffolk.
 E-mail: sales@sealey.co.uk
 Web: www.sealey.co.uk

RE92/20 - 1 - 260902

UNIVERSAL PULL CLAMP & ROTATING RING

Model RE92/20

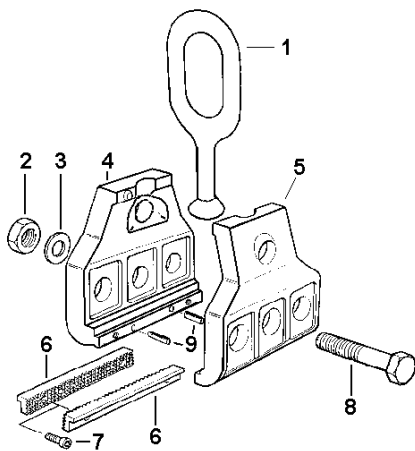
PARTS DETAILS



Item	Part No.	Description	Item	Part No.	Description
1	184.D2510300	Ring, Rotating	6	184.D4030600	Clamp Plate
2	184.C0005226	Nut, M16	7	184.C0004005	Screw, M5x10
3	184.C0006517	Plain Washer, D16	8	184.C0000142	Screw, M16x85
4	184.D6000500	Jaw, Threaded	9	184.C0010515	Pin, D5x14
5	184.D6000600	Jaw, Plain			

For a copy of our latest catalogue and promotions call us on 01284 757525 and leave your full name, address and postcode.



Sole UK Distributor, Sealey Group,
 Bury St. Edmunds, Suffolk.
 E-mail: sales@sealey.co.uk
 Web: www.sealey.co.uk

RE92/20 - 1 - 260902

UNIVERSAL PULL CLAMP & ROTATING RING

Model RE92/20

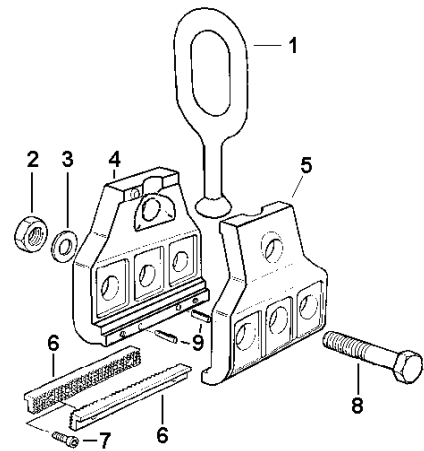
PARTS DETAILS



Item	Part No.	Description	Item	Part No.	Description
1	184.D2510300	Ring, Rotating	6	184.D4030600	Clamp Plate
2	184.C0005226	Nut, M16	7	184.C0004005	Screw, M5x10
3	184.C0006517	Plain Washer, D16	8	184.C0000142	Screw, M16x85
4	184.D6000500	Jaw, Threaded	9	184.C0010515	Pin, D5x14
5	184.D6000600	Jaw, Plain			

For a copy of our latest catalogue and promotions call us on 01284 757525 and leave your full name, address and postcode.

Sole UK Distributor, Sealey Group,
 Bury St. Edmunds, Suffolk.
 E-mail: sales@sealey.co.uk
 Web: www.sealey.co.uk

RE92/20 - 1 - 260902

SAFETY WARNING

This product should not be used without a safety cable. In the event of the puller/clamp becoming detached from the vehicle bodywork when under tension a safety cable will minimise the risk of serious injury.

Pull Clamp Safety Cable (fig.1), Model Number RE92/SC, is available from your Sealey dealer.

After attaching the puller/clamp to the bodywork, but before applying any tension, one end of the safety cable should be clipped to the puller/clamp chain and the other end passed through the bodywork and then also clipped to the chain, as shown in fig. 2.

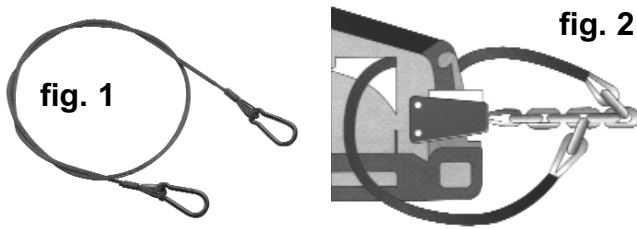

For a copy of our latest catalogue and promotions call us on 01284 757525 and leave your full name, address and postcode.

SEALEY POWER PRODUCTS	Sole UK Distributor, Sealey Group, Bury St. Edmunds, Suffolk.	E-mail: sales@sealey.co.uk Web: www.sealey.co.uk
01284 757500	01284 703534	

RE92/20 - 1 - 260902

SAFETY WARNING

This product should not be used without a safety cable. In the event of the puller/clamp becoming detached from the vehicle bodywork when under tension a safety cable will minimise the risk of serious injury.

Pull Clamp Safety Cable (fig.1), Model Number RE92/SC, is available from your Sealey dealer.

After attaching the puller/clamp to the bodywork, but before applying any tension, one end of the safety cable should be clipped to the puller/clamp chain and the other end passed through the bodywork and then also clipped to the chain, as shown in fig. 2.

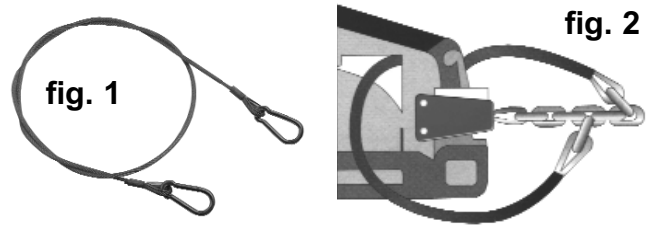

For a copy of our latest catalogue and promotions call us on 01284 757525 and leave your full name, address and postcode.

SEALEY POWER PRODUCTS	Sole UK Distributor, Sealey Group, Bury St. Edmunds, Suffolk.	E-mail: sales@sealey.co.uk Web: www.sealey.co.uk
01284 757500	01284 703534	

RE92/20 - 1 - 260902

SAFETY WARNING

This product should not be used without a safety cable. In the event of the puller/clamp becoming detached from the vehicle bodywork when under tension a safety cable will minimise the risk of serious injury.

Pull Clamp Safety Cable (fig.1), Model Number RE92/SC, is available from your Sealey dealer.

After attaching the puller/clamp to the bodywork, but before applying any tension, one end of the safety cable should be clipped to the puller/clamp chain and the other end passed through the bodywork and then also clipped to the chain, as shown in fig. 2.

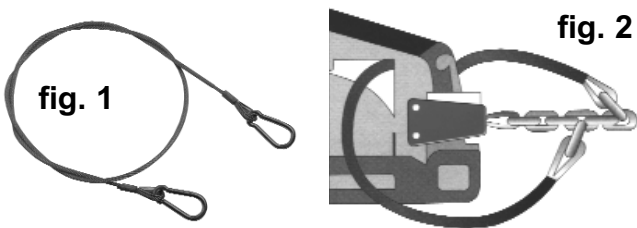

For a copy of our latest catalogue and promotions call us on 01284 757525 and leave your full name, address and postcode.

SEALEY POWER PRODUCTS	Sole UK Distributor, Sealey Group, Bury St. Edmunds, Suffolk.	E-mail: sales@sealey.co.uk Web: www.sealey.co.uk
01284 757500	01284 703534	

RE92/20 - 1 - 260902

SAFETY WARNING

This product should not be used without a safety cable. In the event of the puller/clamp becoming detached from the vehicle bodywork when under tension a safety cable will minimise the risk of serious injury.

Pull Clamp Safety Cable (fig.1), Model Number RE92/SC, is available from your Sealey dealer.

After attaching the puller/clamp to the bodywork, but before applying any tension, one end of the safety cable should be clipped to the puller/clamp chain and the other end passed through the bodywork and then also clipped to the chain, as shown in fig. 2.

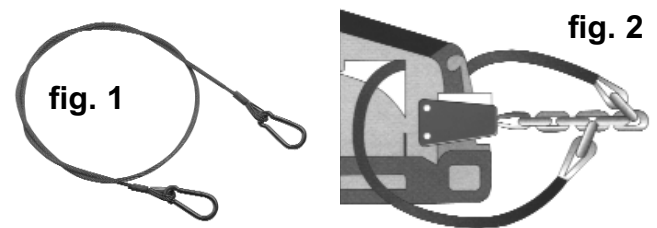

For a copy of our latest catalogue and promotions call us on 01284 757525 and leave your full name, address and postcode.

SEALEY POWER PRODUCTS	Sole UK Distributor, Sealey Group, Bury St. Edmunds, Suffolk.	E-mail: sales@sealey.co.uk Web: www.sealey.co.uk
01284 757500	01284 703534	

RE92/20 - 1 - 260902